

4. Commissioning

4.1. Setting up the ProPulse

- ▶ Ensure that the device has a stable resting place.
- ▶ Check the ProPulse for damage.
- ▶ Apply power to the ProPulse device by plugging it into an electrical outlet. Once power is applied to the ProPulse device, it will take approximately 15 seconds to 'boot up'.



- ▶ There is no on/off switch for the device. The button to the right of the display screen only turns the screen illumination on and off.

4.2. Registering a New Flic Switch

This will only apply if you need to register a new Flic Switch. The Flic Switch sent with the new device has already been registered and only requires synchronization for use. **If registration of a new Flic Switch is required, the device must be connected to Wifi. See section 6.5 to connect to WiFi.**

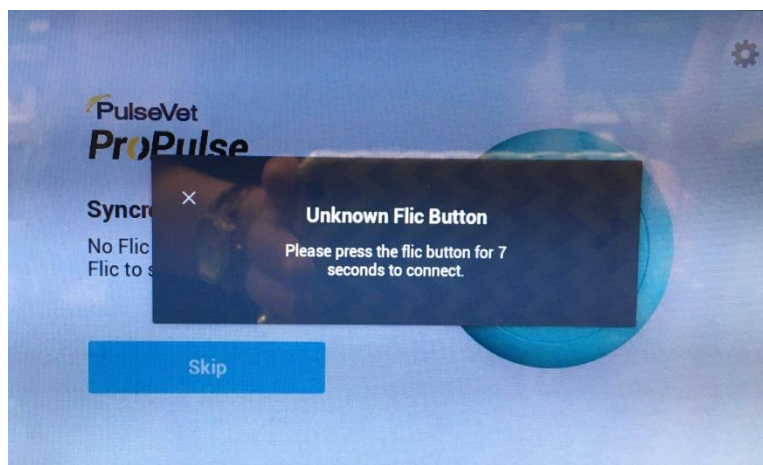

To register the Flic switch, press and hold the Flic Button for approximately 7 seconds and then release button.

4.3. Synchronizing the Registered Flic with the ProPulse

When power is applied to the ProPulse it requires synchronization with the Flic button. The Screen may prompt you to press the Flic Button to 'synchronize your Flic'. Press the Flic button briefly and then release button.

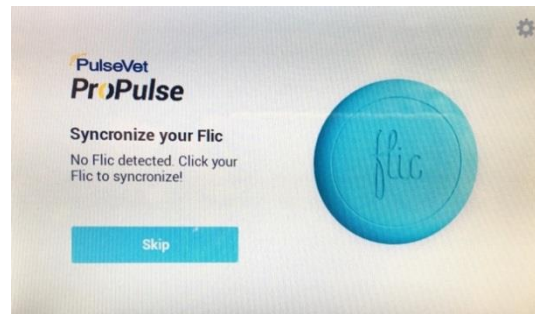

Note

The Flic Switch operates off of a CR2016 battery that will eventually need to be replaced. This battery can be purchased at your local electronics store.

4.3.1. Changing the Flic Switch Battery

Rotate the back piece counter-clockwise approximately 1/8 inch, replace battery, and replace the back piece.



4.3.2. Flic Switch out of Range or Times Out

If the Flic Switch is out of range (more than 20 feet) or if it's been out of use for an extended period of time, it will flash red when you press it. If this happens, bring the Flic button back into range or, if it has timed out, restart the device to resynchronize the Flic switch.